

See K-85

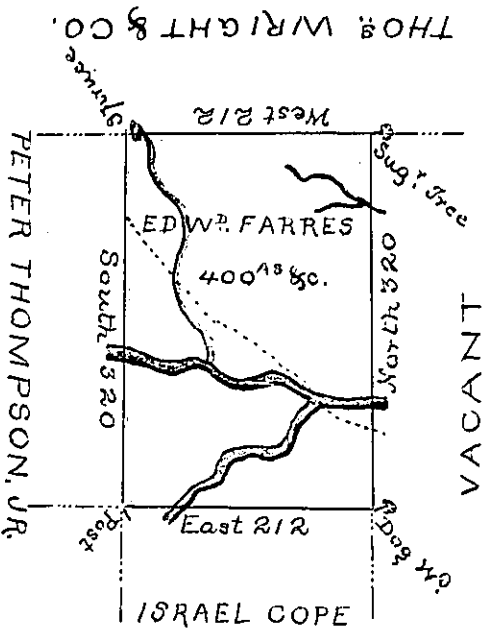

(Don't Use)

Draft of a tract of land called situate in the  
 County of Luzerne containing four Hundred Acres  
 & allow<sup>e</sup>. Surveyed for Edw<sup>d</sup>. Farres the 17<sup>th</sup> day of Sep<sup>r</sup>.  
 1793 by virtue of a warrant dated the 6<sup>th</sup> day of Aug-  
 ust 1793

To

by Wm Gray D. S.

Daniel Brodhead Esq<sup>r</sup>. }  
 Surv<sup>r</sup>. Gen<sup>l</sup>. }

IN TESTIMONY that the above is a copy of the original remaining on file in the  
 Department of Internal Affairs of Pennsylvania, made con-  
 formably to an Act of Assembly approved the 16th day of  
 February, 1833, I have hereunto set my Hand and caused  
 the Seal of said Department to be affixed at Harrisburg, this

fifth day of July 1884.

J. Simpson Africa,  
 Secretary of Internal Affairs.